

artspace **Know Before You Go**

Summer Camps and Field Trips

Artspace wants to welcome students and campers! This guide will help students to understand the layout of the building and where to go.



Contents

1 **Summer Camp**

- Check In
- Lunch Time
- Check Out

5 **Field Trips**

6 **Social Situations**

- Visiting Artists in Their Studios
- Learning Studio
- Quiet Space

9 **Artspace Floor Plan**

Summer Camp

Join Artspace for 8 weeks of fun and creativity during our Summer Camp program! We offer week-long summer art camps taught by professional artists. During camp, students explore the creative process and produce one-of-a-kind projects. They will also get to meet our resident Studio Artists and see the current exhibitions on view.

Campers should come dressed in clothing that they can get messy in. Layers are best in case it is cold or hot. Please wear closed-toed shoes for safety.

Supplies for summer camp sessions are provided unless otherwise stated in course descriptions.

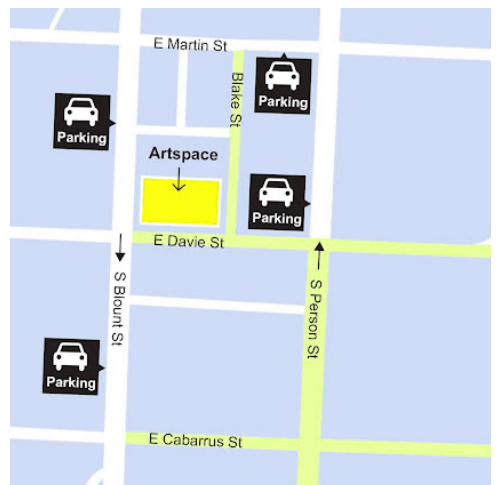
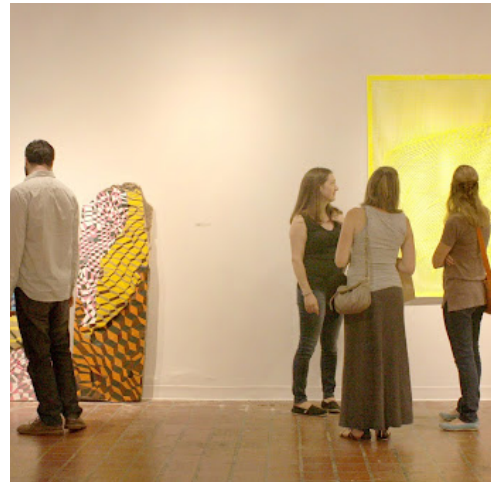



Checking In

Parents are required to bring their camper into the Artspace lobby daily before class to sign them in. Please do not drop your camper off at our curb or across the street. This is for their safety. Campers that are 14+ can have their parents grant permission for self-check-in and check-out during registration.

- Morning drop off is at 8:30–9am.
- The front door will be locked when you arrive. A volunteer or staff member will open the door for you.
- Tables will be set up in the lobby with stations for each class. Go to the table with the sign for your camper's class to check them in.
- The lobby will be full of parents and campers checking in, and it may be noisy.
- Morning classes start at 9am and run until 12pm.
- Campers will be guided as a group to their classroom by a volunteer or staff member.



Lunch Time

- At 12pm, half day campers will go home or arrive, and full day campers will break for lunch.
- Campers can bring lunch from home, or order lunch ahead of time from our lunch vendor.
- If a camper brings lunch, they can keep it in the classroom with them, in a place off to the side of the room. If lunch items need to be kept cold, campers can ask a teacher, Artspace staff member, or volunteer to take it to the refrigerator and return it when it's time to eat.
- Afternoon classes start at 1pm and run until 4pm.

Checking Out

To check campers out, parents or guardians must show their ID. For your camper's safety, any adult not listed as a Sign Out Person (SOP) will not be allowed to check them out. Campers that are 14+ can

have their parents grant permission for self-check in and check-out during registration.

- Afternoon pick up time is 4–4:30pm.
- Staff or volunteers will bring campers to the lobby where they will wait to be checked out.
- The front door will be locked when you arrive. A volunteer or staff member will open the door for you.
- Go to the table with the sign for your camper's class to check them out.
- The lobby will be full of parents and campers checking out, and it may be noisy.
- Parents are expected to pick up their child on time. There is a \$5 late fee charge for each 5 minutes after 4:30pm. Repeated instances of late pick up will result in dismissal from the program with no refund.

Field Trips

Artspace offers Field Trips that are adaptable for groups of all ages and abilities! On our tours, students learn about the history of Artspace, explore our current exhibitions, and meet our resident Studio Artists. Artspace tour guides and staff create inclusive, collaborative experiences that offer the chance to discover more about our exhibitions through sensory and interactive elements. After the tour, participants can put what they learned into practice through a hands-on art activity with professional artists.

When you arrive for your field trip, an Artspace staff member will greet your group in the lobby. Depending on the size of your group, you may be broken into smaller groups. The staff member will show you where you can safely leave personal items if you would prefer not to carry them with you. Since some of our floors are uneven, please wear comfortable shoes. There are benches and portable stools available if you need to take a rest.

Sensory kits are available upon request. These include fidgets and noise reducing headphones.

Social Situations

Visiting Artists in their Studios

While visiting Artspace campers and students will get to experience gallery spaces with many different types of art. There is no right or wrong way to experience art, but please remember to:

- Walk slowly when you are in the galleries.
- Please do not touch the artwork. Our hands (even when they are clean) have oils on them that could damage the art.
- Ask questions if you are curious.



Campers and students may also get to visit artists while they work in their studio spaces. Visitors will be guided to open studios and will be able to go in and look at the art and talk with the artists about their work. Examples of questions you could ask are:

- What materials do you use to make your work?
- What do you like about those materials?
- What inspires you?
- What subject(s) does your work explore?
- What work do you most enjoy doing?
- What is your dream project?



Learning Studio

While visiting Artspace, you may have the opportunity to explore in the Learning Studio. This is a permanent classroom space, located on the first floor. This space will give campers and students an opportunity for more hands-on learning and exploration.

Quiet Space

Need a place to take a break? There is a designated quiet space located in our Learning Studio on the first floor. The space has soft seating, and some sensory tools. There is a dimmer in the room for those who need less light. *Please note: the Quiet Space is open during Artspace's regular hours, but is only available to students in the Learning Studio during our Summer Camp season.*



Please ask Artspace staff and teachers if you need assistance during your visit. Staff will be wearing name tags. You can find more accessibility information on Artspace's website, resources can be found at artspacenc.org/accessibility-resources.

If you have questions before your visit or if you are unsure if your needs will be met, you can contact our Visitor Services + Experience Team, April Hagins and Anna Pickard at (919) 821-2787 or by emailing info@artspacenc.org. We look forward to your visit!

Artspace Floor Plan

First Floor

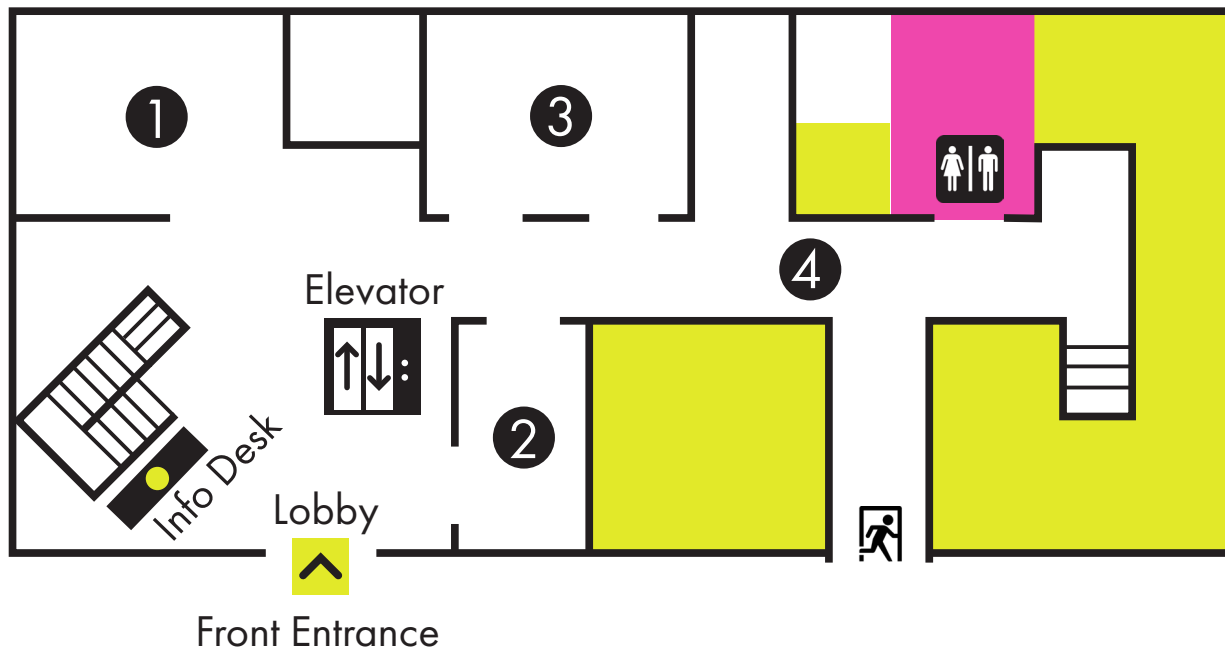

Second Floor

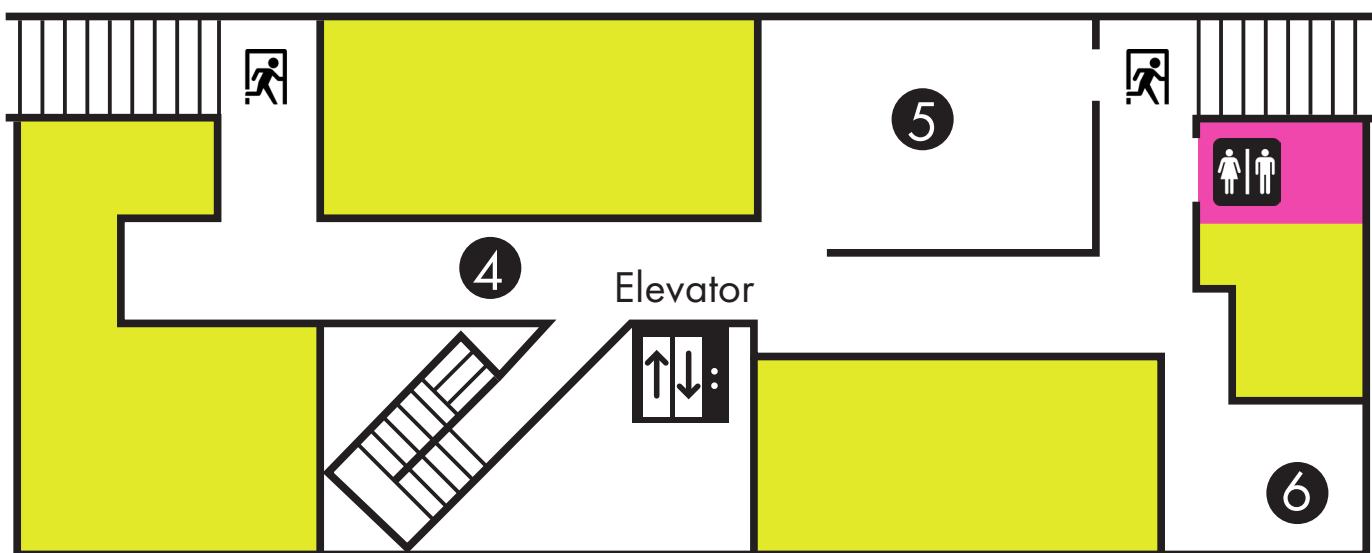

Key

- | | | |
|------------------|-------------------|-------------------|
| ① Gallery 1 | ② Upfront Gallery | ③ Learning Studio |
| ④ Corridors | ⑤ Gallery 2 | ⑥ Studio 206 |
| ■ Artist Studios | 🚻 Restrooms | 🚶 Emergency Exits |